

K-301L-AS

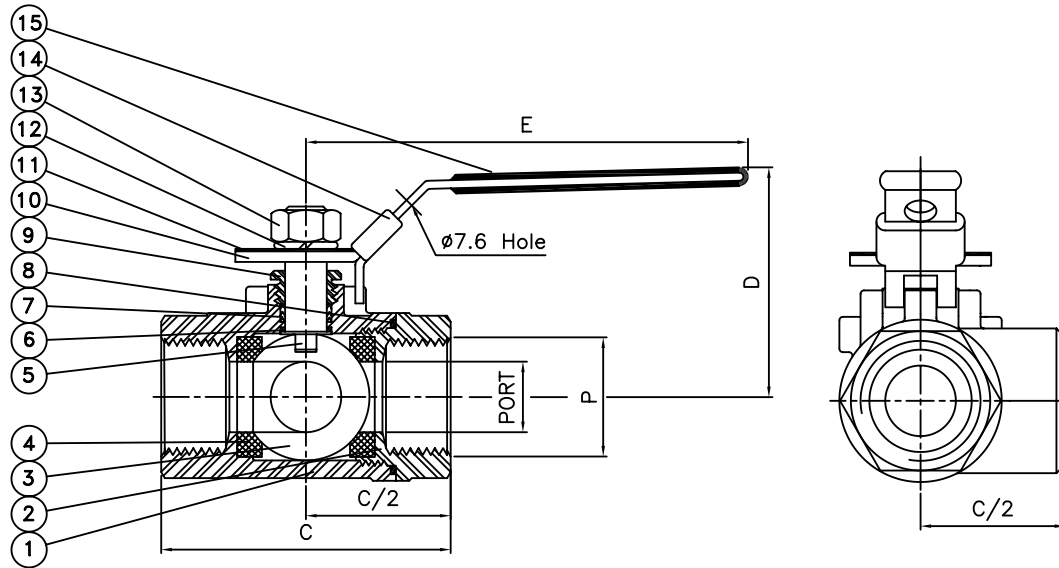
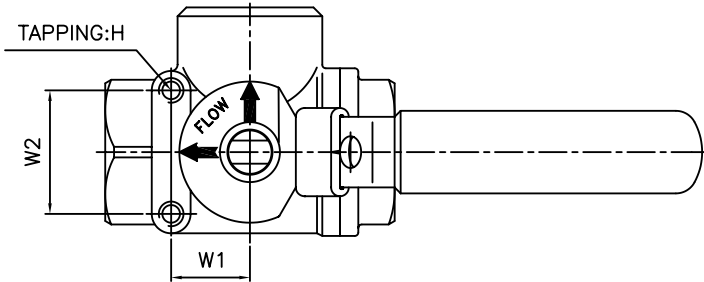

MATERIAL LIST

No.	PART NAME	SPECIFICATION	Q'TY
1	BODY	CF8M	1
2	END CAP	CF8M	1
3	BALL	SS316	1
4	SEAT RING	REINFORCED TFE	2
5	STEM	SS316	1
6	THRUST WASHER	REINFORCED TFE	1
7	STEM PACKING	TEFLON	1 SET
8	JOINT GASKET	TEFLON	1
9	GLAND NUT	SS304	1
10	HANDLE	SS304	1
11	FLOW INDICATOR	SS304	1
12	HANDLE WASHER	SS304	1
13	HANDLE NUT	SS304	1
14	LOCKING DEVICE	SS304	1
15	HANDLE COVER	PLASTIC	1

DIMENSIONS (MM)

SIZE	PORT	C	D	E	W1	W2	H	P	
1/4"	11.2	60	56	95	12.7	28.5	10-24 UNC	1/4"	PF or NPT
3/8"	11.2	60	56	95	12.7	28.5	10-24 UNC	3/8"	PF or NPT
1/2"	12.7	60	56	95	12.7	28.5	10-24 UNC	1/2"	PF or NPT
3/4"	16.0	76	64	125	22.4	35.0	10-24 UNC	3/4"	PF or NPT
1"	20.0	82	66	125	22.4	35.0	10-24 UNC	1"	PF or NPT
1-1/4"	25.0	97	70	145	22.4	35.0	10-24 UNC	1-1/4"	PF or NPT
1-1/2"	32.0	114	83	145	25.4	38.1	1/4"-20 UNC	1-1/2"	PF or NPT
2"	38.1	142	88	205	25.4	38.1	1/4"-20 UNC	2"	PF or NPT



銓剛實業股份有限公司

VALAND INDUSTRIAL CORPORATION



ANGLE

1001-2500	± 0.50	± 1.50
251-1000	± 0.20	± 1.00
64-250	± 0.20	± 0.50
17-63	± 0.10	± 0.30
5-16	± 0.07	± 0.20
1-4	± 0.05	± 0.15
SIZE	MACHINING	INV.CASTING

DRAWING

DESIGN

CHECK

APPROVE

DATE

UNIT

SCALE

MATERIAL

Sep.03,1996

MM

FREE

DESCRIPTION

K-301L 3 WAY L-PORT  
STANDARD PORT 1000WOG

DRW.No.

K-301L-AS