

VL-401-AS

MATERIAL LIST

No.	DESCRIPTION	SPECIFICATION
1.	BODY	ASTM A-351 GRADE CF8M
2.	END CAP	ASTM A-351 GRADE CF8M
3.	BALL	SS316
4.	SEAT RING	PTFE
5.	BODY SEAL	PTFE
6.	THRUST WASHER	PTFE
7.	STEM SEAL	PTFE
8.	STEM	SS316
9.	GLAND NUT	SS304
10.	HANDLE WASHER	SS304
11.	HANDLE NUT	SS304
12.	HANDLE	SS304
13.	HANDLE COVER	PLASTIC

DIMENSIONS (MM)

SIZE	PORT	L	H	W	P
1/4"	10	54	45	98	1/4" PF or NPT
3/8"	12	54	45	98	3/8" PF or NPT
1/2"	16	68	62	125	1/2" PF or NPT
3/4"	20	76	65	125	3/4" PF or NPT
1"	25	88	83	140	1" PF or NPT
1-1/4"	32	98	89	140	1-1/4" PF or NPT
1-1/2"	40	120	100	200	1-1/2" PF or NPT
2"	50	134	108	200	2" PF or NPT

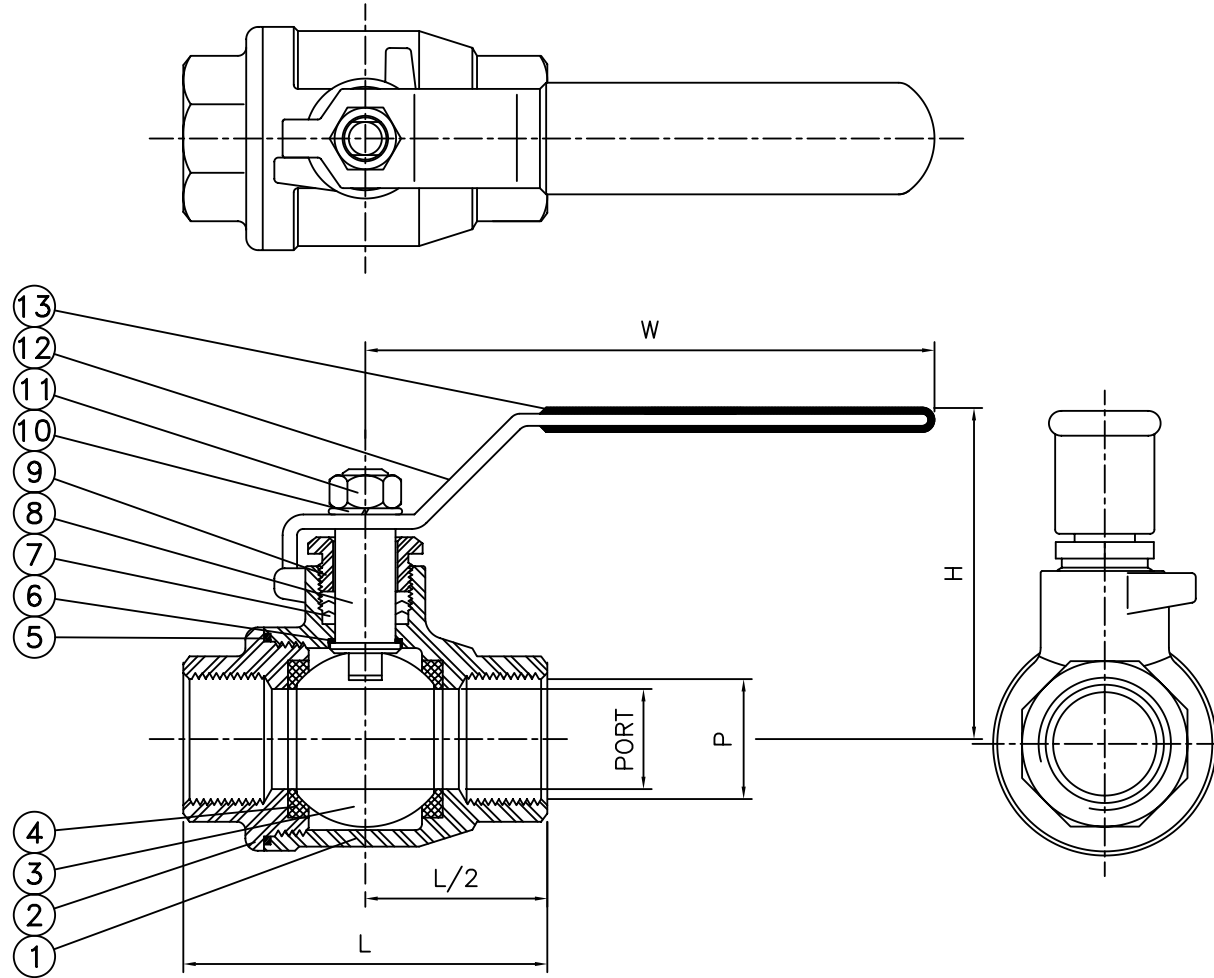

銓剛實業股份有限公司

VALAND INDUSTRIAL CORPORATION



ANGLE

1001-2500	± 0.50	± 1.50
251-1000	± 0.20	± 1.00
64-250	± 0.20	± 0.50
17-63	± 0.10	± 0.30
5-16	± 0.07	± 0.20
1-4	± 0.05	± 0.15
SIZE	MACHINING	INV.CASTING

DRAWING

DESIGN

CHECK

APPROVE

DATE

UNIT

SCALE

MATERIAL

Aug.01,1997

MM

FREE

DESCRIPTION

VL-401 2PC
FULL BORE BALL VALVE
THREADED,1000WOG

DRW.No.

VL-401-AS